

**SPEIRS  
MAJOR**

Shenzhen Bao'an International Airport,  
China

**LIGHT  
ARCHITECTURE**

8 Shepherdess Walk  
London,  
N1 7LB  
United Kingdom

T +44 (0)20 7067 4700

Co-lab Shibuya Cast  
23-21, Shibuya 1-Chome  
Tokyo 150-0002  
Japan

T +81 (0)3 3400 8855

[info@smlightarchitecture.com](mailto:info@smlightarchitecture.com)  
[press@smlightarchitecture.com](mailto:press@smlightarchitecture.com)

# SPEIRS MAJOR



Light and the passenger experience over a 24-hour cycle: light effortlessly reveals the building and highlights key orientation features.

CLIENT  
Shenzhen Airport

EXECUTIVE ARCHITECT  
BIAD

ARCHITECT  
Fuksas Architects

PHOTOGRAPHER  
Leonardo Finotti

PROJECT TEAM  
Keith Bradshaw,  
Carrie Donahue  
Bremner



# SPEIRS MAJOR



# SPEIRS MAJOR

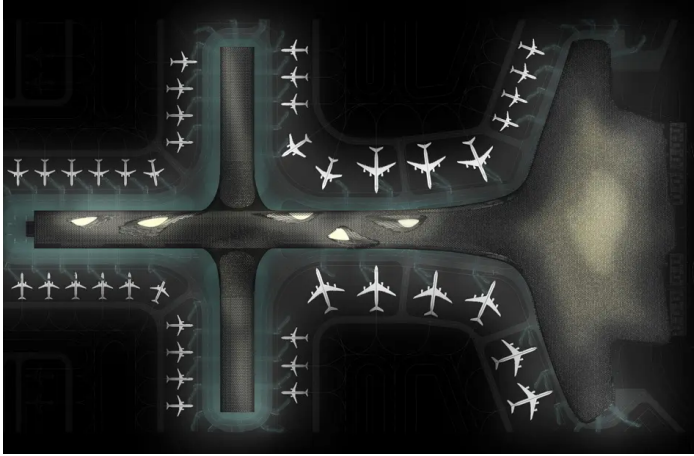

Special care was taken to understand how passengers would perceive the light. We conducted several studies to assess the effects of light distraction and uniformity, and tailored the lighting at the windows and glass walls to preserve views out.

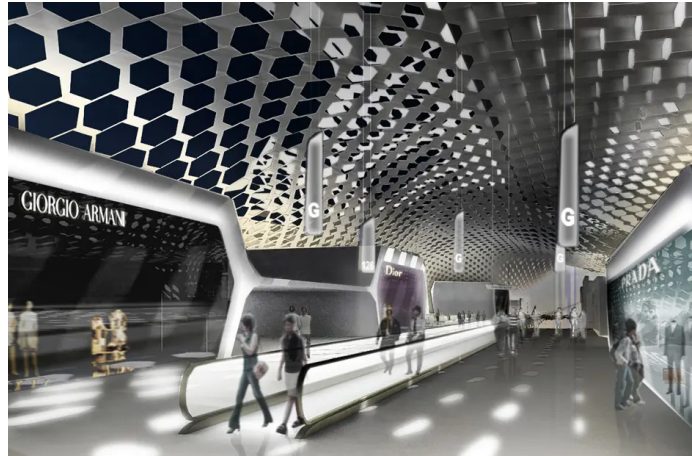

The 1.5km long building, designed by Studio Fuksas, features a unique undulating double skin roof punctuated by thousands of hexagonal shaped skylights. These create beautiful patterns of light and shadow that animate interior surfaces.

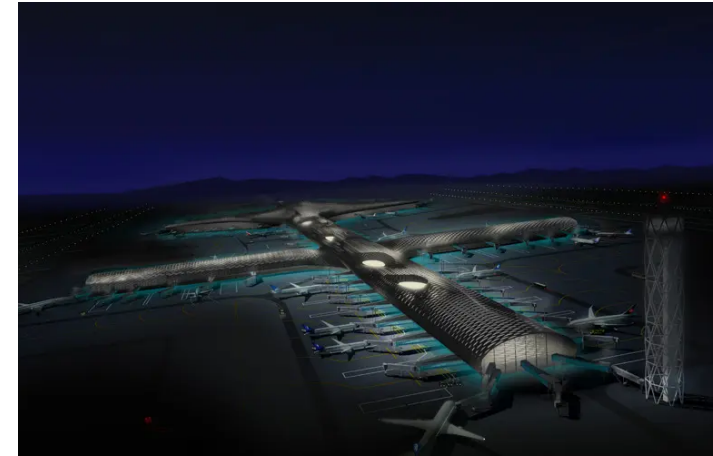

The roof we made into a feature in its own right by lighting the void between the skins, creating a 'paper lantern effect' that lifts and frames the space at night.



# SPEIRS MAJOR

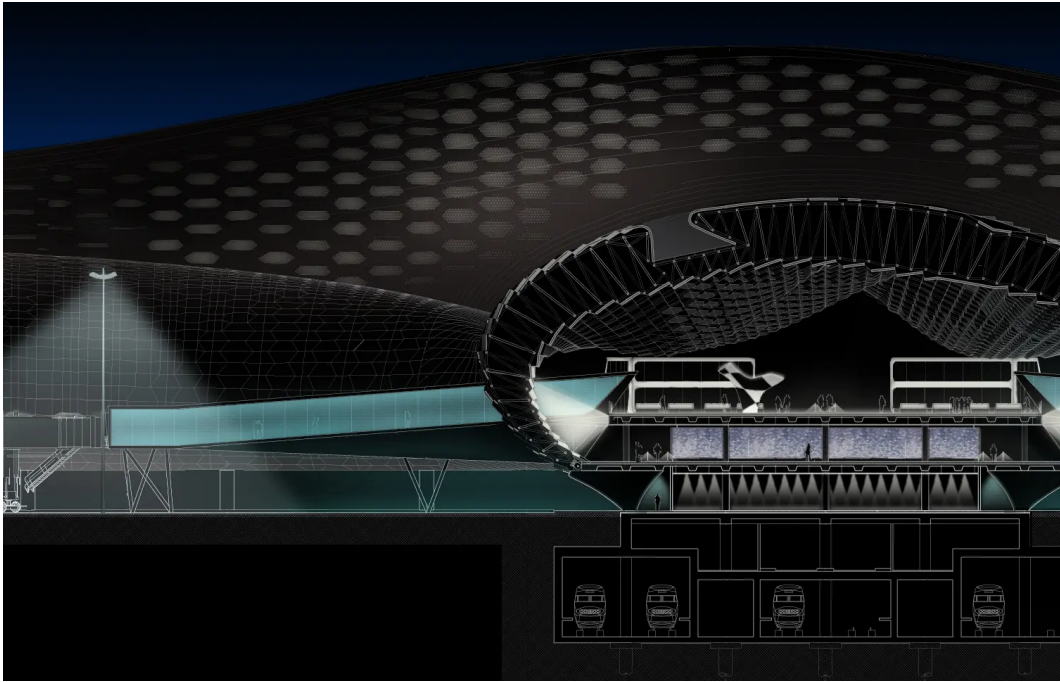

Outside, the iconic nature of the building demanded lighting that would contribute to a strong identity after dark. .

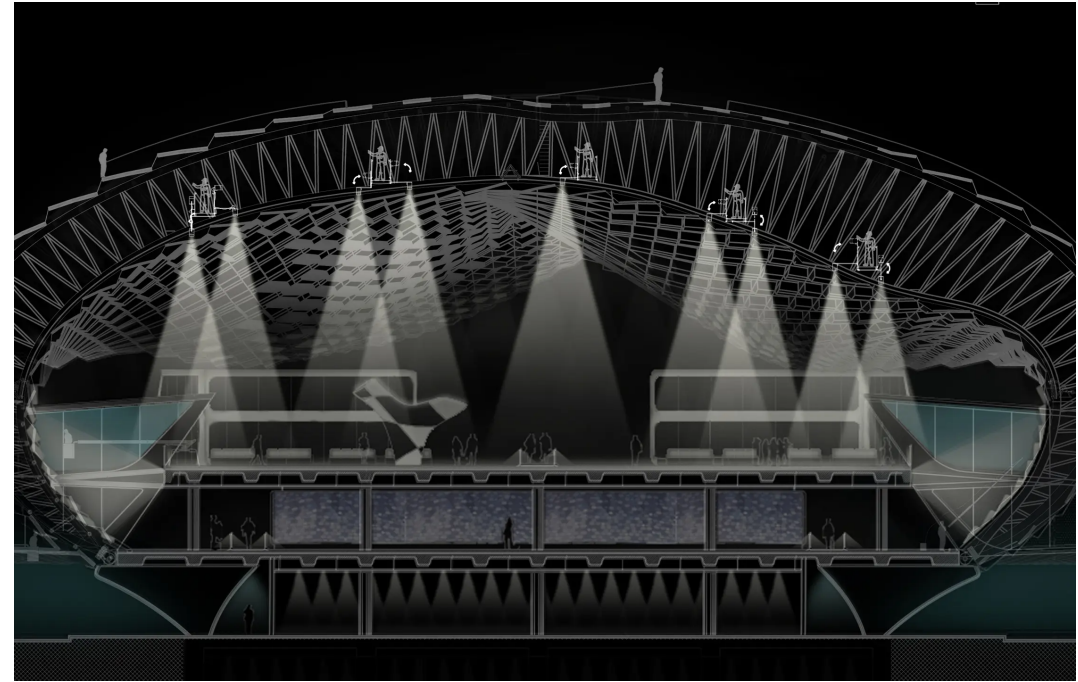

We washed saturated pale cyan light at apron level and under the building to create the impression that the building is floating on a lagoon, and repeated the effect for the air bridges, creating a visual link between the plane and the terminal.